

LawnMaster®

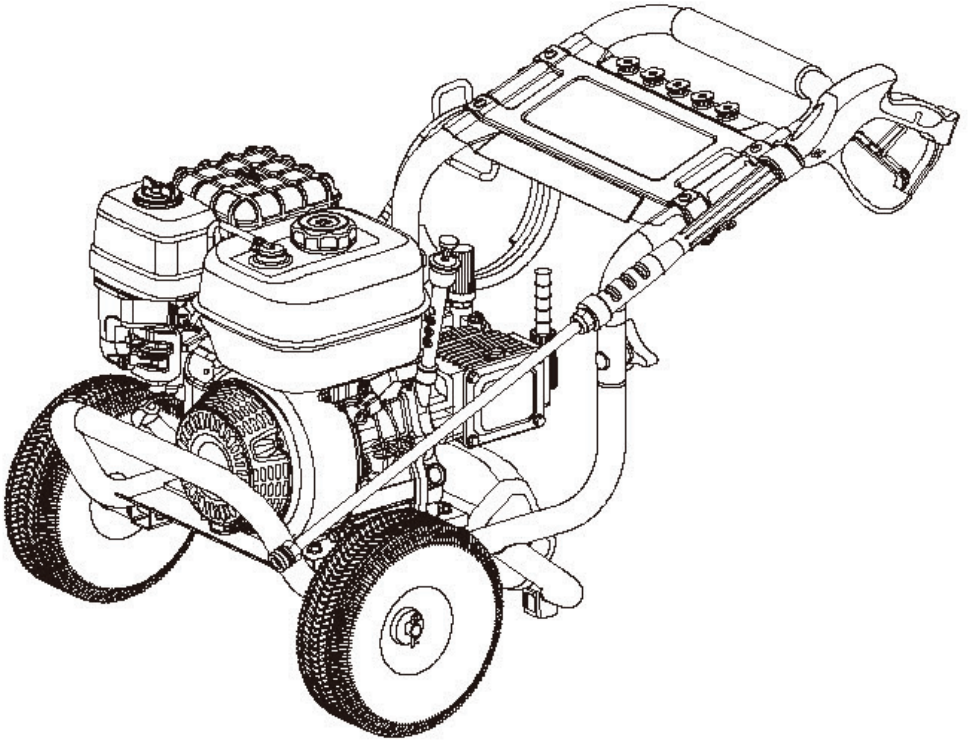

3600 PSI PETROL HIGH PRESSURE CLEANER

SAFETY AND OPERATING MANUAL

PLEASE READ THIS MANUAL CAREFULLY BEFORE OPERATING THE UNIT

LMPCHP3600



A STEELFORT PRODUCT



PROUDLY
NZ OWNED



TABLE OF CONTENTS

| | |
|---|-----------|
| OPERATOR SAFETY | 3 |
| Safety Rules | |
| FEATURES & TECHNICAL DATA | 5 |
| OPERATION & ASSEMBLY | 7 |
| Unpacking | |
| Assembly - Mounting Handrail & Connecting Water Pipe & Pressure Jet | |
| Operating Checklist | |
| Changing Dipstick | |
| Engine Oil/Fuel | |
| Soap Solution | |
| Accessory Assemble | |
| Starting & Stopping Engine | |
| MAINTENANCE | 12 |
| Maintenance Schedule | |
| Engine Oil | |
| Changing Oil | |
| Foam & Paper Filter | |
| Spark Plug | |
| Valve Lash Adjustment | |
| Pressure Jet | |
| Pressure Gun | |
| Water Inlet & Filter | |
| High Pressure Water Pipe | |
| TROUBLE ANALYSIS & TROUBLESHOOTING | 16 |
| STORAGE & TRANSPORTATION | 17 |
| WARRANTY | 17 |

Thank you for purchasing our LawnMaster LMPCHP3600 High Pressure Cleaner, the information contained within this manual will help you to have many years of safe and trouble free use of this LawnMaster product.

OPERATOR SAFETY

SAFETY RULES

This manual contains important safety information and instructions to operate the LawnMaster LMPCHP3600 High Pressure Cleaner.

PLEASE READ THIS MANUAL CAREFULLY BEFORE USING THE UNIT.

Failure to adhere to the safety instructions could result in property damage and/or serious personal injury.

This manual should be considered a permanent part of the pressure cleaner and should remain with the unit at all times. All information in this publication is based on the latest product information available at the time of printing.

Product Information and specifications can be altered and/or improved without notice. Content from this publication may not be reproduced without written consent.

DANGER

Indicates a hazardous situation which, if not strictly complied with, will result in substantial property damage and or serious injury.

WARNING

Indicates a hazardous situation which, if not strictly complied with, may result in property damage

CAUTION

Indicates a hazardous situation which, if not strictly complied with, could result in property damage or personal injury.

WARNING

The warnings and precautions discussed in this manual does not cover all possible conditions and or scenarios that may occur.

It must be understood by the operator that common sense and caution must be taken into consideration

when operating this product, as these are factors which cannot be built into this manual.

DO NOT operate this pressure cleaner until you have read ALL safety, operation, and maintenance Instructions listed in this manual. Failure to follow the instructions may result in property damage, INJURY or DEATH.

The warnings and precautions discussed in this manual cannot cover all possible conditions and situations that may occur. It must be understood by the operator that common sense and caution are factors which cannot be built into this product, but must be possessed by the operator.

The warnings and precautions discussed in this manual cannot cover all possible conditions and situations that may occur. It must be understood by the operator that common sense and caution are factors which cannot be built into this product, but must be possessed by the operator.

- Before each use, check for loose or damaged parts, signs of oil or fuel leaks, and any other condition that may affect proper operation. Repair or replace all damaged or defective parts immediately.
- Locate all operating controls and safety labels.
- Keep all safety guards in place and in proper working order at all times.
- DO NOT allow any material to block the cooling slots.
- DO NOT allow children or untrained persons to operate the engine.
- DO NOT run the cleaner unattended. Turn off the pressure cleaner before leaving.

WARNING - KICKBACK

- Rapid retraction of the starter cord will pull hand and arm towards the engine faster than you can let go.
- Unintentional startup can result in entanglement, traumatic amputation or laceration. Broken bones, fractures, bruises or sprains could result.

WARNING

Read the instructions provided with the equipment that powered by this engine for any additional safety rules that should be observed in conjunction with cleaner startup shutdown, operation, or protective apparel that may be needed to operate the equipment.

- Position pressure cleaner carefully to avoid grass discoloration from engine heat.
- NEVER spray water at people, pets, or electrical devices.
- Close doors and windows before cleaning; remove debris and hazards from the area.
- Never carry machine while engine is running.
- DO NOT start the machine if any ice is present.
- DO NOT use acids, alkalines, solvents, flammable materials, bleaches, or industrial grade solutions to prevent harm to users and machine damage.
- Operate machine on level ground to prevent engine seizing, even with maximum lubrication.
- Hold trigger handle securely with both hands to control reaction forces.
- DO NOT make adjustments while the engine is running unless recommended by the manufacturer.
- Ensure protective covers are in place over rotating parts while engine is running.
- Keep cooling air intake and muffler side of the engine at least 1M away from buildings and obstacles.
- Avoid contact with hot engine parts, including muffler and exhaust gases, to prevent burns and injuries.
- DO NOT touch spark plug and ignition cable during operation.
- Check fuel hoses and joints for leaks before each use.
- Refuel outdoors in well-ventilated areas; never indoors.
- Do not store machine with fuel inside in buildings with ignition sources.
- Drain fuel tank outdoors into an approved container away from ignition sources if necessary.
- Handle fuel with care due to its high flammability to reduce the risk of fire and injury.
- Do not smoke while handling fuel.
- Loosen fuel cap slowly to release pressure and prevent fuel spillage.
- Wipe spilled fuel from the unit; move 10M away from the refueling site before starting the engine.
- If fuel is spilled, do not attempt to start the engine; move the machine away and avoid ignition sources until fuel vapors dissipate.
- Never burn off spilled fuel under any circumstances.
- Before storing, allow the pressure cleaner to cool for 30 minutes and drain fuel from the unit.
- Store fuel in a cool, well-ventilated area, safely away from spark-producing equipment, in a container specifically designed for it.
- Empty fuel tank and secure unit before transporting in a vehicle.
- Use only recommended or equivalent replacement parts to avoid hazards or product damage.
- Only use cold water.
- Maintain a minimum clearance of 1M from combustible materials.
- Avoid spraying too close to surfaces to prevent damage.
- After stopping the engine, pull the trigger handle to release stored pressure in the high-pressure hose to avoid injury.
- For outdoor use only.
- DO NOT operate the pressure cleaner if you're under the influence of drugs, alcohol, or medication.

FEATURES & TECHNICAL DATA

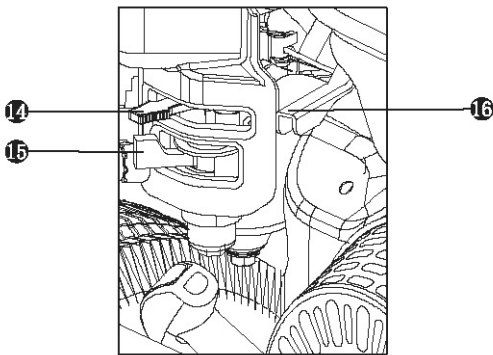
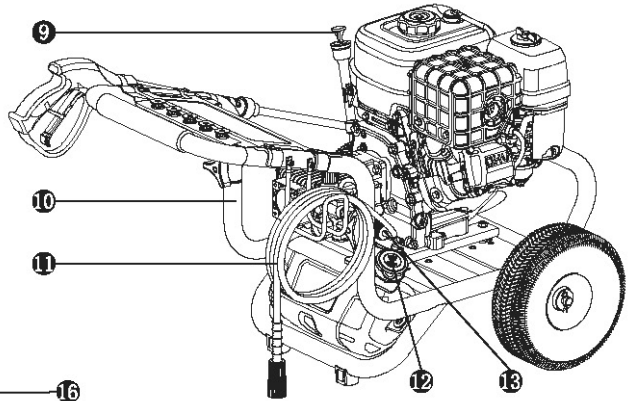
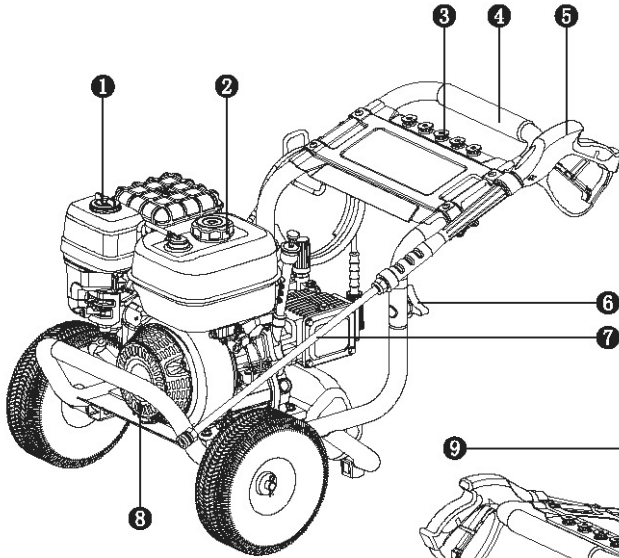

- | | | |
|-------------------|-----------------------|--------------------------|
| 1. Air Filter | 7. Gun Barrel | 13. Water Outlet |
| 2. Fuel Cap | 8. Recoil Starter | 14. Choke Lever |
| 3. Pressure Jet | 9. Dipstick | 15. Fuel Switch |
| 4. Handrail | 10. Rack | 16. Speed Control Handle |
| 5. Pistol Grip | 11. Pressure Pipe | |
| 6. Connecting Nut | 12. Soap Solution Pot | |

| | |
|-------------------|--------------------|
| Model | LMPCHP3600 |
| Engine Model | GB270B |
| Type | Petrol Engine |
| Starting System | Recoil Start |
| Rated Power (kW) | 5.8 |
| Oil Type | SAE 10W-30 |
| Fuel Capacity (L) | 4.2 |
| Oil Capacity (L) | 0.8 |
| Bore (mm) | 75 |
| Stroke (mm) | 61.5 |
| Compression Ratio | 8.6:1 |
| Rated Flow | 12.5L/min |
| Outlet Pressure | 3050 PSI (21Mpa) |
| Rated Pressure | 3600 PSI (24.8MPa) |
| Recoil Pressure | 3700PSI (25. 5Mpa) |
| Loading Speed | 3400-3600 (r/min) |

Note: Any changes to the engine or related data for your pressure cleaner may not be communicated. Engine may difference in various areas, please contact your local LawnMaster dealer for engine information.

OPERATION & ASSEMBLY

UNPACKING

1. Place the shipping carton on a solid, flat surface.
2. Carefully cut each corner of the carton box from top to bottom. Fold each side flat on the ground.
3. Remove everything from the carton except the high pressure cleaner.

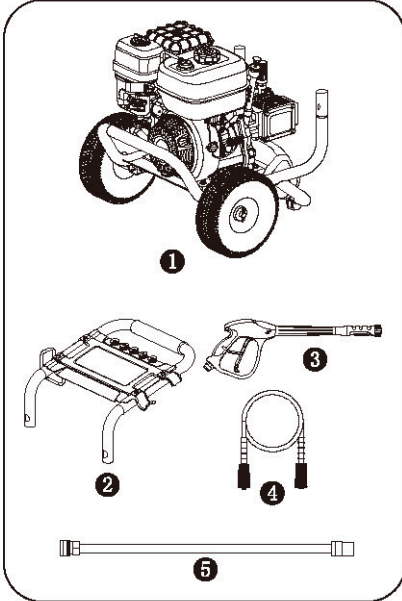

1. LMPCHP3600 High Pressure Cleaner
2. Handrail Assembly
3. Pistol Grip
4. Pressure Pipe
5. Gun Barrel

ASSEMBLY

Your pressure cleaner requires some assembly. If you have any questions regarding the assembly of your cleaner, please have your model number and serial number ready and consult your local LawnMaster dealer for help.

1. MOUNTING HANDRAIL

Mount the handrail as shown in the figure ,insert the bolt and fasten the frame connecting

nuts.

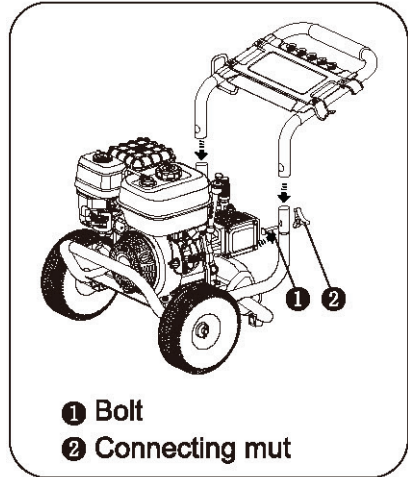

1. Bolt
2. Connecting Nut

2. CONNECT WATER PIPE & PRESSURE JET

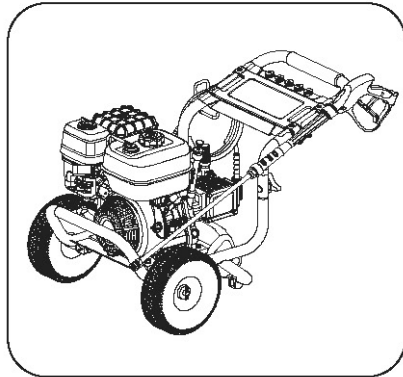

OPERATING CHECKLIST

1. OPERATING LOCATION

- Only use OUTSIDE and place the cleaner in a well-ventilated area and only operating cleaner in a suitable usage, consult your local LawnMaster dealer if you have any question about engine usage.
- Place the cleaner on a stable and flat surface, and keep surroundings clean and dry.

- Additional rules may be comply if cleaner is used in some specific area and condition, consult your local LawnMaster dealer for more information.

DANGER - TOXIC FUMES

The engine's exhaust emits carbon monoxide, a deadly gas that is odorless and colorless. Using the engine indoors can be fatal. NEVER operate it inside any building or enclosure, even with doors and windows open. Position the engine outdoors in a well-ventilated area, taking into account wind and air currents for safety.

2. OPERATING CONDITION

- Check for any loose or damaged parts, as well as oil or fuel leaks. Replace or repair anything damaged right away.

WARNING

Failing to correct problem(s) before operation could result in property damage, serious injury or DEATH.

- Remove any excessive dirt or debris, especially around the muffler and recoil starter.
- Do not move or turn over the cleaner when engine operating.

3. ENGINE OIL

1. Place the engine on a level surface with engine stopped.
2. Remove the dipstick and wipe it clean.
3. Reinstall dipstick into tube; rest on oil fill neck, DO NOT thread cap into tube.

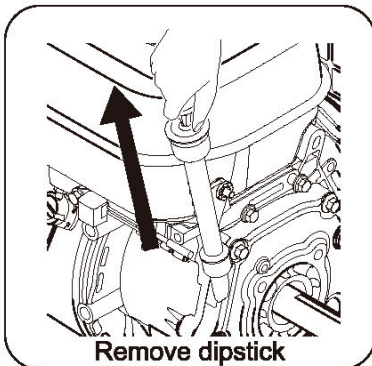

4. Remove the dipstick again and check oil level. Level should be at top of indicator on dipstick.

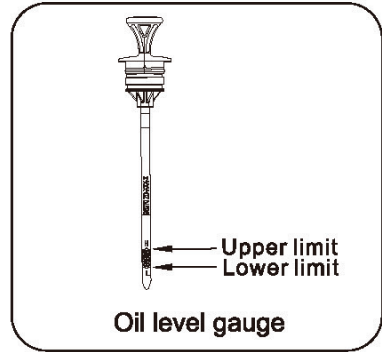

5. Fill to the upper limit of the dipstick with the recommended oil if the oil level is low. SAE 10W-30 is recommended.
6. Reinstall and fully tighten the dipstick.

Refer to add oil instruction in MAINTENANCE section for more information.

4. CHANGE THE DIPSTICK OF PUMP

1. Take out plug 1, put in plug 2 for running.

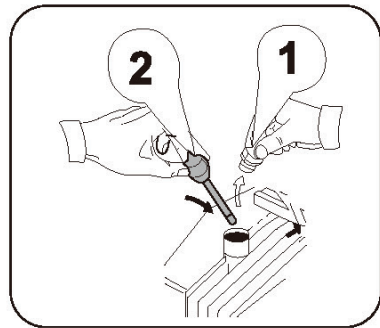

WARNING

This engine is not filled with oil at the factory. Any attempt to crank or start the engine before it has been properly filled with the recommended type and amount of oil may result in engine damage and void your warranty.

CAUTION

Operate the cleaner on a flat surface only. The engine has a low oil sensor that automatically shuts down when oil levels are too low. To prevent accidents, keep oil levels at the upper limit and check them regularly.

WARNING

Oil is a major factor affecting performance and service life. Use 4-stroke SAE 10W-30 oil which is recommended in the MAINTENANCE section of this manual.

5. ENGINE FUEL

With the engine stopped, check the fuel level gauge. Refill the fuel tank if necessary.

CAUTION

Pressure can build up in the fuel tank. Allow the engine to cool for at least two minutes before removing fuel cap. Loosen the fuel cap slowly to relieve any pressure in the tank.

1. Use clean, fresh regular unleaded petrol.
2. DO NOT mix oil with petrol.
3. Be sure not to fill above the upper limit mark. Always allow room for fuel expansion.

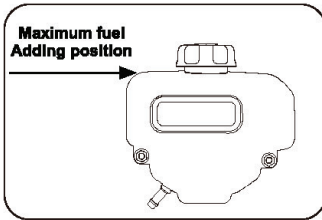

DANGER

DO NOT overfill the fuel tank beyond the upper limit. Overfilling can cause the engine to stall or damage the carbon canister (if equipped), which will void your warranty.

DANGER - FIRE OR EXPLOSION

- Petrol is highly explosive.
- DO NOT refuel the cleaner while it's operating or when it's hot.
- Keep flammable items away from petrol. Refuel the cleaner outdoors and in a well-ventilated area with the cleaner turned off.
- Always clean up spilled petrol and wait for it to dry before starting the cleaner.
- DO NOT use the cleaner if there are known leaks in the fuel system. Follow proper petrol storage and handling procedures, and avoid storing petrol or flammable materials nearby.
- Keep a fire extinguisher handy and be prepared in case of a fire.

Avoid using engine or carburetor cleaner products in

the petrol tank to prevent permanent damage.

Prevent gum deposits in essential fuel system parts during storage. Alcohol-blended fuels like gasohol, ethanol, or methanol can attract moisture, leading to separation and acid formation, damaging the fuel system during storage.

Follow storage instructions carefully. Only use petrol/alcohol blends containing up to 10% alcohol and 90% unleaded petrol by volume; other blends are not approved. Stale or contaminated fuel effects are not covered by warranty.

CAUTION

To minimise gum deposits in your fuel system and to insure easy starting, add fuel if needed. Always use fresh fuel when operating the Pressure Cleaner.

6. SOAP SOLUTION

Open the pot cap to add soap solution.

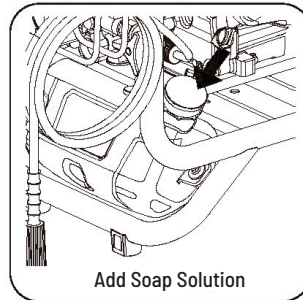

MAX: 3.97L

CAUTION

Do not use any detergent with function of bleaching or solution.

7. ACCESSORY ASSEMBLING

1. Connect high pressure pipe with pump outlet.

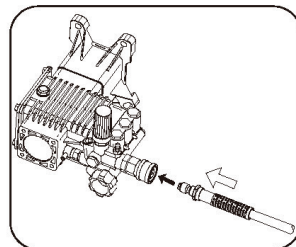

- Verify the filter screen is in water inlet of pump. Connect water outlet pipe with pump water inlet. (The thread specification of the water inlet is 3/4-11.SNH (GHA), and the user needs to purchase an appropriate connector for assembly.)

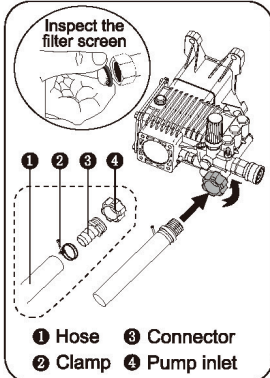

- Connect the gun barrel with pistol grip.

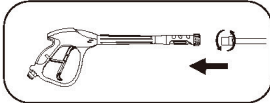

- Connect the pistol grip with high pressure pipe.

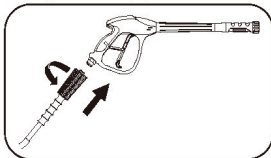

- Select jet

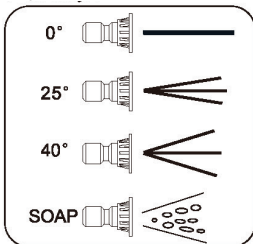

CAUTION

The siphon function is only effective during low-pressure jet operation. Opt for the black low-pressure jet when using the cleaner, rather than the high-pressure option.

| No. | 0°jet In red | 25°jet In green | 40°jet in white | jet in black |
|-----------------------|---|--|---|--|
| | | High pressure | High pressure | High pressure |
| Descript- -ption | Cutting jet | Suction jet | Cleaning jet | Washin g jet |
| Opera- -tion | Jet water in a straight line with high pressure, it could wash from point to point. | Jet water in a 25° sector with high pressure, it is the common jet. | Jet water in a wide sector with high pressure, it is used for a large area cleaning. | Jet water in a wide sector with low pressure, meanwhile self-suction produced in pump suction. |
| Washi- -ng item | Dirty on concrete on surface or other stuff that hard to wash | Washing house surroundings, sidewalk, off-house furniture and back yard. | Cleaning the car, the window, aluminum house body and some other non-high pressure suffering surface. | Detergent jets in a style of soap also for rinse. |

- Install the jet

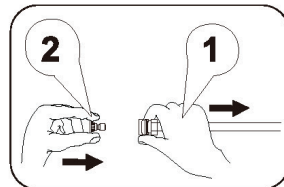

- Open water inlet pipe faucet.

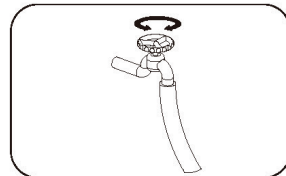

- To inspect the spray gun, first release the safety latch. Then, pull the trigger of the lance holder for 30 seconds to purge air from the pipe. Toggle the spray gun on and off repeatedly to ensure it operates normally.

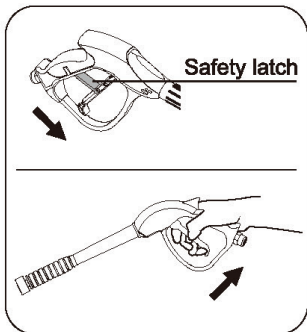

NOTE: Engage the safety latch to the spray gun trigger after use.

STARTING THE ENGINE

CAUTION

Operate the cleaner when inlet pipe leak or without water will result in cleaner damage.

1. Perform operating checklist.
2. Turn the fuel switch to "ON" position. Turn the choke lever to "CHOKE" position (If the engine is cold)

CAUTION

The choke openings should be adjusted based on temperature and other factors when starting the engine. If the engine needs to be restarted in hot conditions, keep the choke in the ON position when the temperature is above 20°C, and switch it to the OFF position when it's below 20°C.

3. Adjust throttle handle to "START" position.

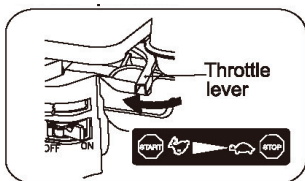

4. When starting engine, grasp the recoil starter handle and pull slowly until resistance is felt. Then pull rapidly to avoid kickback

WARNING

Check starter cord conditions before operating. Have it replaced immediately by local LawnMaster dealer if

cord is frayed.

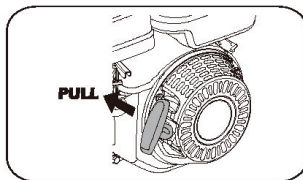

WARNING - KICKBACK

Rapid retraction of the starter cord can pull your hand and arm towards the engine faster than you can let go, potentially causing unintentional startup. This can lead to entanglement, traumatic amputation, or laceration, as well as broken bones, fractures, bruises, or sprains.

CAUTION

If the engine fails to start after three attempts or stalls shortly after starting, check to ensure that the high-pressure cleaner is placed on a flat surface and that there is enough oil in the engine.

Check oil level when engine is in break-in process, see maintenance chapter for recommended maintenance schedule.

5. Move choke lever slowly to "RUN" position and check if engine running stable and any other noise.

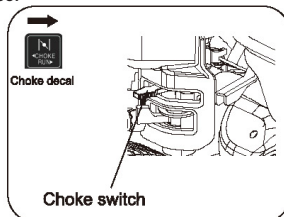

6. Choose a suitable jet, and handle jet tightly, start the cleaner aiming at item.

WARNING

Avoid gun keep "OFF" position for long time, it may result in pump damage or personal injury.

CAUTION

When operating the cleaner, wear eye protection to safeguard your eyes. Strong kickback can occur when the high-pressure water jet is released. Avoid operating the cleaner on wet or slippery surfaces to prevent accidents. Ensure you tightly grip the handle when using the cleaner.

Different jets serve different functions, so choose the appropriate one for optimal washing effectiveness and to protect the surface being cleaned.

DANGER

The high-pressure jet of water acts like a cutter, capable of penetrating skin or clothing easily. Avoid aiming the cleaner at yourself, others, or pets to prevent injury.

STOPPING THE ENGINE

1. Release the pistol grip to stop the jet and let engine run for 10 seconds

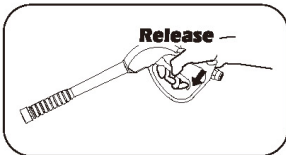

2. Adjust throttle handle to "STOP" position.

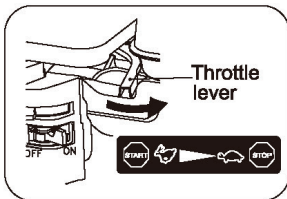

3. Turn off the tap

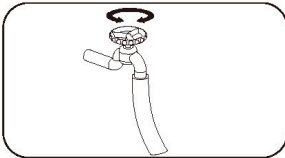

4. Turn on the jet to release the pipe inner pressure.

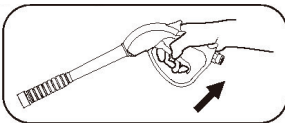

WARNING

High-pressure water may remain in the pressure pipe, posing a risk of injury by penetrating the skin. Always remember to release the jet pressure after stopping the engine or when discontinuing water supply.

5. Remove the water pipe.

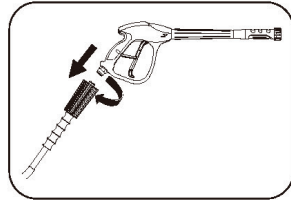
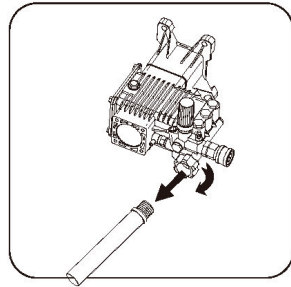

6. The way to stop engine on emergency: remove the spark plug or turn the stop lever to "0" position.

DANGER

Do not stop engine with load unless any emergency happens.

MAINTENANCE

Owner/operator must perform scheduled maintenance promptly. Address any issues before using the cleaner. Follow manual's inspection and maintenance guidelines. Before servicing, release jet pressure and let engine cool.

DANGER

Accidental starts can be fatal. Disconnect and ground spark plug wire before servicing.

WARNING

Improper maintenance or neglecting to fix issues before operation can lead to malfunctions, causing property damage, serious injury, or death. Neglecting maintenance will void your warranty.

CAUTION

The filter element may contain PAHs, PAHs are harmful to your health. Please wear gloves for protection during air filter maintenance.

MAINTENANCE SCHEDULE

Service the pressure cleaner in a clean, dry and flat area. Follow the service intervals indicated in the chart below. Service your pressure cleaner more frequently when operating in adverse conditions. Contact your local LawnMaster service dealer for your pressure cleaner maintenance needs.

| | | EACH TIME BEFORE USE | FIRST MONTH OR 5 HOURS ^{*1} | EVERY 3 MONTHS OR 25 HOURS ^{*1} | EVERY 6 MONTHS OR 50 HOURS ^{*1} | EVERY 12 MONTHS OR 100 HOURS ^{*1} |
|--------------------|-------------------------|----------------------|--------------------------------------|--|--|--|
| Engine Oil | Inspection | ✓ | | | | |
| | Replacement | | ✓ | | ✓ | |
| Air Filter | Inspection | ✓ | | | | |
| | Clean | | | ✓ ^{*2} | | |
| Spark Plug | Inspection & Adjustment | | | | ✓ | |
| | Replacement | | | | | ✓ |
| Jet | Clean | | | | ✓ | |
| Gun | Inspection & Adjustment | | | | | ✓ ^{*3} |
| Valve Clearance | Inspection & Adjustment | | | | | ✓ ^{*3} |
| High Pressure Pipe | Inspection | Every 2 years | | | | |
| Oil Tube | Inspection | Every 2 years | | | | |

* 1: Before each season and after then (whichever comes first).

* 2: Service more frequently under severe, dusty, dirty conditions.

* 3: To be performed by knowledgeable, experienced owners or a LawnMaster service dealer.

GENERAL MAINTENANCE

- Use a wet cloth to clean surface of the cleaner.
- Use a soft brusher to remove the dirty and oil on surface.
- Use compressed air (25PSI) to clean all remaining dirt on the cleaner.
- Check all ventilation and cooling paths to keep them unblocked and clean.

WARNING

Using water to clean the cleaner is forbidden since water may pass through the cooling path and result in rust. Tampering with settings or modifying engine speed is forbidden and voids warranty.

ENGINE OIL

SAE 10W-30 is recommended for general use across all temperatures. You can also use other viscosities indicated in the chart if the average temperature in your area falls within the specified range.

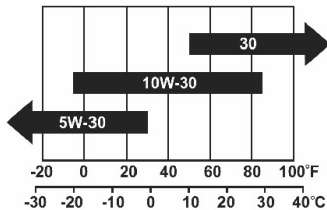

ADD OIL

1. Place the engine on a level surface.
2. Remove the dipstick.

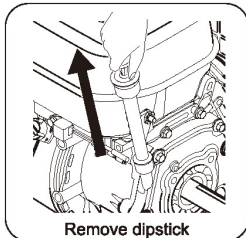

3. Add recommended oil type to the upper limit

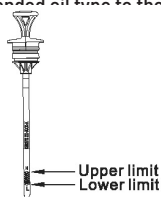

CAUTION - OIL LEVEL CHECK

Reinstall dipstick into tube; rest on oil fill neck, DO NOT thread cap into tube.

4. Completely screw the dipstick.

CHANGE OIL

CAUTION

Change the oil when the engine is warm from running.

1. Place the cleaner on a level surface.
2. Remove oil dipstick.
3. Remove the oil drain plug and allow the oil to drain completely.
4. Replace and fully tighten the drain plug.
5. Add recommended oil to the upper limit
6. Reinstall and fully tighten the dipstick.
7. Dispose of used oil at an approved waste management facility.

WARNING

The engine is not filled with oil at the factory. Any operation before it has been properly filled with the recommended type and amount of oil may result in engine damage and void your warranty.

AIR FILTER

1. Unscrew the nut and remove the cover of the air cleaner.

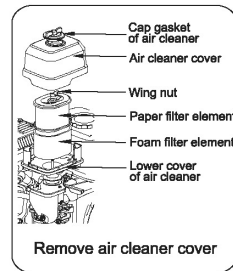

2. Loosen the wing nut to remove the filter.
3. Cleanup the filter.
4. Reassemble the filter back to the units.
5. Fasten cover with the screw down nut.

FOAM FILTER ELEMENT:

Place the foam filter element in liquid detergent and warm water to wash it. Wrap it in a clean cloth and squeeze it to dry completely. Then soak it in clean engine oil, wrap it in a clean absorbent cloth, and squeeze out the excess oil.

PAPER FILTER ELEMENT:

Tap the hard surface of the filter element several times to dislodge the dirt. Do not use a brush to remove the dirt, as this can cause it to fall into the filter paper. Replace the filter element if it is too dirty.

WARNING

DO NOT run the engine without the air filter, serious danger can result.

SPARK PLUG

Bosch WR7DC+ / NGK BPR7ES

1. Clean any dirt from the spark plug cap and spark plug base.
2. Remove the spark plug cap.
3. Using socket wrench to loose and remove the spark plug.
4. Inspect the spark plug and spark plug cleaner, if it's damaged or worn, replace with new one. Clean the spark plug with wire brush if reuse it.
5. Check spark plug gap. Carefully bend side electrode to adjust the gap if necessary.

Spark plug gap: 0.6mm - 0.8mm

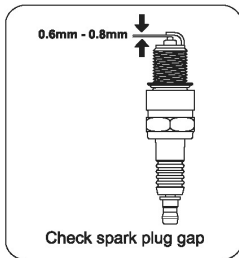

6. Carefully thread the plug into the engine by hand.
7. After the spark plug seated, use spark plug wrench to tighten it.

Spark plug tighten torque: 20-25 N.m

8. Attach the spark plug wire to the plug.

WARNING

Only use recommended spark plug or equivalent. DO NOT use spark plugs that have improper heat range.

VALVE LASH ADJUSTMENT

Each petrol engine is debugged and inspected strictly

by the company in the factory. Generally, the machine can work properly without any adjustments. After use for sometime you may need adjust the gap as follows:

Note: Gap Standard

Intake Gap (0.10mm-0.15mm)

Exhausted Gap (0.15mm-0.20mm)

1. Hold the valve gap adjusting nut, and release the valve locking nut.
2. Rotate the valve gap adjusting nut to a predetermined gap.
3. Hold the valve gap adjusting nut and tighten the valve locking nut according to the redetermined torque.
4. Tighten the valve locking nut and then check the valve gap again until it is in the line with the standard.

PRESSURE JET

If the water jet is deformed or uneven, it indicates a blockage in the nozzle. Use a fine pin to insert into the nozzle to remove the blockage.

PRESSURE GUN

Check the gun barrel when the engine is at low speed or turned off. Connect the water supply, then repeatedly turn the jet on and off to ensure the pistol operates smoothly. Finally, check for any leaks.

WATER INLET AND FILTER

Check the water inlet pipe for any fractures and inspect the pump filter for any blockages.

HIGH PRESSURE WATER PIPE

Visually inspect the high-pressure water pipe for any leaks.

DANGER

High-pressure water can burst from the pipe if it leaks while the high-pressure cleaner is operating. This water burst can penetrate the skin and cause injury. Therefore, please check the pipe for leaks before each use.

TROUBLE ANALYSIS & TROUBLE-SHOOTING

| Item | Problem Shooting | Solution |
|---|---|---|
| No pressure or little water when jet; vibration and pressure unstable | <ol style="list-style-type: none"> 1. Mount with low pressure jet. 2. Block in inlet pipe. 3. Little water supply 4. Inlet pipe leak or twist. 5. Block in inlet filter. 6. High temperature on inlet water. 7. High pressure outlet block or leak. 8. Jet gun leak. 9. Jet block. | <ol style="list-style-type: none"> 1. Replace with high pressure jet. 2. Clean inlet pipe. 3. Increase water supply 4. Straight pipe to remove leakage. 5. Check and clean inlet filter. 6. Replace with room temperature water. 7. Check outlet pipe to remove block or change a new one. 8. Replace a new jet gun. 9. Clean the jet. |
| Failure to mix detergent | <ol style="list-style-type: none"> 1. Suction pipe opening, not merging in water. 2. Used high pressure jet. | <ol style="list-style-type: none"> 1. Merge the suction opening in to detergent water. 2. Replace with a low pressure jet. |
| Engine cannot start or hunting after start | <ol style="list-style-type: none"> 1. No fuel. 2. Inferior or bad fuel is used. 3. High pressure wire and spark plug connection is flexible. 4. Damage to spark plug. 5. Mixed water in the fuel. 6. Stop button short cut or not working. 7. Engine switch is not open. | <ol style="list-style-type: none"> 1. Add more fuel. 2. Drain bad fuel and refill. 3. Connect them tightly. 4. Replace the spark plug. 5. Drain fuel and refill. 6. Check and remove the causes. 7. Open the switch |
| Engine stalls automatically | <ol style="list-style-type: none"> 1. No fuel. | <ol style="list-style-type: none"> 1. Add more fuel. |
| Engine has low power | <ol style="list-style-type: none"> 1. Air filter. 2. Moving parts worn. 3. Low power on ignition. 4. Spark plug and ignition gap large or small. 5. Carbon store in spark plug. | <ol style="list-style-type: none"> 1. Open the choke. 2. Check and replace. 3. Replace ignition or flywheel. 4. Adjust the gap to a standard valve. 5. Remove the carbon. |

If problems still not be solved according to above problem shooting or other problem caused during operation, contact your local authorised LawnMaster dealer for help.

Unauthorised disassemble will void your warranty.

STORAGE & TRANSPORTATION

STORAGE

DO NOT mix oil with petrol. The engine should be started at least once every 2 weeks and allowed to run for at least 20 minutes. Follow the instructions below for longer term storage if the engine will be out of service for 2 months or more.

DANGER - FIRE OR EXPLOSION

Petrol is highly flammable and extremely explosive. Empty the fuel tank and take back the brake before storing or transporting this engine.

1. Allow cleaner to cool before storage.
2. Service the cleaner according to the instructions in the maintenance section.
3. Drain all fuel completely from the fuel tank, fuel hose and carburetor.
4. Replace oil.
5. Drain of water in outlet pipe and pump.
6. Remove spark plug and pour about 30ml. of engine oil into cylinder. Reinstall spark plug. Crank engine slowly to distribute oil and lubricate cylinder.
7. Mount the spark plug.
8. Use dust-proof or carton to protect machine when storage.
9. Store the unit in a clean, dry area out of direct sunlight.

TRANSPORTATION

To prevent fuel spillage when transporting or during temporary storage, the pressure cleaner should be secured upright in its normal operating position, with the switches OFF.

WARNING - TRANSPORTING

Do not over fill the tank.

Avoid a place exposed to direct sunlight when putting the pump on a vehicle. If the pump is left in an enclosed vehicle for many hours, high temperature inside the vehicle could cause fuel to vaporize resulting in a possible explosion.

Do not drive on a rough road for an extended period with the engine on board. If you must transport the engine on a rough road, drain the fuel from the engine beforehand.

WARRANTY

Subject to the following conditions, this unit is covered by a comprehensive two-year warranty.

The unit is designed for domestic purposes only, issues and faults due to commercial use may not be covered by warranty. The warranty covers all manufacturing faults but excludes normal wear and tear, misuse, neglect, accidental damage or defects arising from failure to comply with instructions as outlined in this owners manual. Only genuine spare parts can be used for repairs and this must be carried out by an authorised LawnMaster Services Dealer to maintain warranty.

Warranty does not cover the cost of transportation of any part(s) but does cover the labour/parts cost incurred in repairing or replacing any defective part(s) consequential or special damages and / or expenses resulting from any defect.

If the unit requires further repairs or services please visit www.lawnmaster.co.nz to find your local LawnMaster dealer.

For all other enquiries contact **Steeffort Customer Services +64 6 350 1350**



LawnMaster®

FIND US



www.lawnmaster.co.nz



lawnmasternz

Steelfort

500 Rangitikei Street, Private Bag 11045
Palmerston North, 4412, New Zealand
06 350 1350

Steelfort Auckland

880 Great South Road, Penrose
Auckland, 1061, New Zealand
09 573 1324